

201 Elizabeth Street Existing Asset

Sydney



Facts	
CLIENT	Charter Hall
LOCATION	201 Elizabeth Street, Sydney NSW
PROJECT SIZE	36,000
TARGET COMPLETION	2023
BASE BUILDING ARCHITECT	WMK
INTERIOR DESIGNER	WMK
CONTRACTOR	Buildcorp

Project Overview

Charter Hall is the owner of this existing 40-storey, commercial office building in the Sydney CBD, which overlooks Hyde Park.

Currently under construction, the refurbishment will include new PCA A grade lifts, upgrade of all on floor base building amenities. Upgrade of all existing floors to the Charter Hall warm shell standards as well and major plant upgrades. All to bring the building up to industry best standards.

The architectural design was undertaken by WMK Architecture who have a significant track record of delivering high quality design solutions for A-Grade commercial buildings.

201 Elizabeth Street Existing Asset

Sydney

The Problem

To ensure the building is attractive to key tenants, Charter Hall has identified the need for major upgrades to meet current PCA A grade, industry best practices, and Charter Hall standards. These upgrades will enable the building to align with the highest standards of quality, functionality, and sustainability, making it an appealing and desirable option for potential tenants.

Our Solution

Solutions Consulting Australia offers a comprehensive range of services that cover all aspects of the project, including but not limited to:

- securing all necessary authority approvals
- managing the design process
- providing value engineering and design optimization services
- coordinating the consultant team
- managing the tendering and procurement of the principal contractor
- providing superintendent, commercial, and retail tenancy coordination services.

Our team has the expertise and experience to ensure the successful delivery of your project, from start to finish



201 Elizabeth Street New Development Sydney

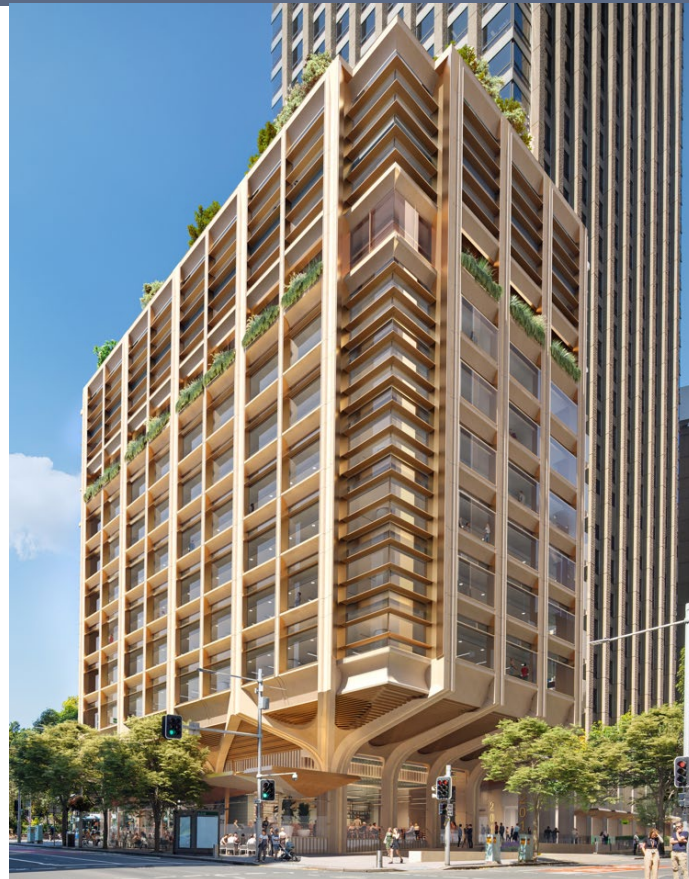

Facts

CLIENT	Charter Hall
LOCATION	201 Elizabeth Street, Sydney NSW
PROJECT SIZE	8,541
TARGET COMPLETION	TBC
BASE BUILDING ARCHITECT	FJMT
INTERIOR DESIGNER	FJMT
CONTRACTOR	TBC

Project Overview

As a result of Charter Hall developing the surplus, permissible GFA on the site of 201 Elizabeth Street, construction of a new PCA A-Grade 10-storey commercial building within the permissible envelope on the north portion of the site is being planned.

The project will include new end-of-trip facilities, a new activated retail precinct and ground floor lobby entrance.

The architectural design was undertaken by FJMT, who have a significant track record of delivering high quality design solutions for A-Grade commercial buildings.

201 Elizabeth Street New Development Sydney

The Problem

Charter Hall has set a requirement for the new 10-story development to seamlessly integrate with the existing tower. In addition, Charter Hall had specified that the end of trip facilities, ground floor entry, and retail spaces need to be completely redesigned and optimized to transform the building into a destination building that meets the highest standards of quality, functionality, and sustainability. This is required to ensure Charter Hall are best placed to secure new Tenants to the building.

Our Solution

Solutions Consulting Australia in partnership with Census Advisory was engaged by Charter Hall to manage all aspects of the project as well as undertake development, project management, and superintendent roles.

Solutions Consulting Australia offers a comprehensive range of services that cover all aspects of the project, including but not limited to:

- securing all necessary authority approvals
- managing the design process
- providing value engineering and design optimization services
- coordinating the consultant team
- managing the tendering and procurement of the principal contractor
- providing superintendent, commercial, and retail tenancy coordination services.

Our team has the expertise and experience to ensure the successful delivery of your project, from start to finish





SOLUTIONS CONSULTING
AUSTRALIA

Contact

Andrew Steventon

Andrew.steventon@solutionsconsulting.com.au

+61 412 925 650

Hutch Bykerk

hutch.bykerk@solutionsconsulting.com.au

+61 423 116 647

Level 14, 130 Pitt St, Sydney 2000

www.solutionsconsulting.com.au



Disclaimer

Some of the information, images and illustrations in this project case study may be indicative only and subject to change. Computer generated images and renderings may have been used to give an indication of the project. The particulars are set out as a general outline only. All descriptions, references and other details are given in good faith and are believed to be correct at the time of printing. Project case study produced by Polymer Studios.

